

item number	for width of	for height of	B	thickness of	
	cable tray	cable tray			
	(A)	(H)		metal sheet	
	mm	mm	mm	mm	
<b>NIXKO 90X50X62_IX</b>	62	50	240	0,8	🔥
<b>NIXKO 90X50X125_IX</b>	125	50	240	0,8	🔥
<b>NIXKO 90X50X250_IX</b>	250	50	240	0,8	🔥
<b>NIXKO 90X100X125_IX</b>	125	100	290	0,8	🔥
<b>NIXKO 90X100X250_IX</b>	250	100	290	0,8	🔥
<b>NIXKO 90X100X500_IX</b>	500	100	290	0,8	🔥



**product description:** The low elbow is designed for the transition between a horizontal and sloping (vertical) cable tray.  
Connect by inserting the cable tray directly into the accessories and securing it with NIXSM 6X10 bolts. To protect the cables, the bolt head is inside the cable tray.

**surface finish:** IX - stainless steel AISI 304 (AISI 316, AISI 316L only to order)

**sales amount:** á 1 pc

**meets the requirements:** EN 61537:02

**classification 🔥:** ČSN 73 0895 P 90-R  
DIN 4102-12 E 90  
STN 92 0205 PS 90  
Fire classification is depend on the specific conditions of the cable tray, detailed in the catalog Systems with maintained functionality in fire

**storage:** EN 60721-3-1

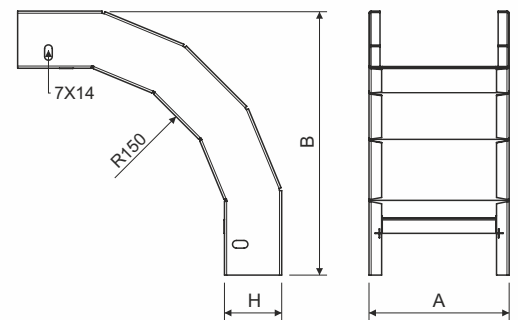

 **WARNING****Risk of injury from cutting**

Although the cable trays are produced with maximum effort to minimize sharper edges, it is necessary to wear protective gloves to carry, grip and work with cable elements.

**Electricity injury**

As individual components of cable management systems are made of electrical conductive material, it is essential not to work with a system near live electrical parts. Infringement of the safety regulations may cause serious injury of health or death.

**Safe Use**

Under normal and foreseeable conditions of use, there are no risks to consumers, provided that proper installation and usage are carried out in accordance with the installation manual.

recycling codes:



NIXKO